



Congratulations on the purchase of your new poly lumber rocker. These easy step-by-step instructions can be used for assembling any of the following rockers.



**Adirondack Rocker**  
(This style is used for instructions)



**Harbor Rocker**



**Lake Shore Rocker**

## Important

### **Please Read All Instructions Carefully Before Assembling This Product**

- Inspect all parts to make sure that nothing is broken or missing. If something is broken or missing, please contact our service department at [support@eccboutdoor.com](mailto:support@eccboutdoor.com).
- The rocker must be completely assembled before attempting to use it. Failure to do so could result in damage to the chair or the user.
- Use proper safety gear and follow appropriate safety precautions when assembling this product.
- **Important - Do not overtighten the screws.**
- Only hand tools should be used for assembly. Do not use power tools.
- ECCB Outdoor will not be liable for any injury or damage resulting from improper assembly and/or use of this product.
- Failure to follow all instructions will result in the product warranty being voided.

# Parts

Make sure you have received everything. If anything is missing or damaged, please contact our service department at [support@eccboutdoor.com](mailto:support@eccboutdoor.com).

**(A)** Back - 1 pc

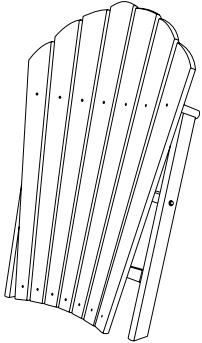

**(B)** Seat - 1 pc

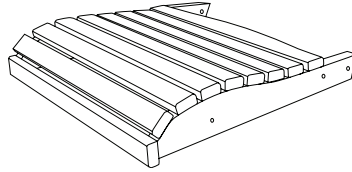

**(C)** Arms - 2 pcs  
1 Right  
1 Left

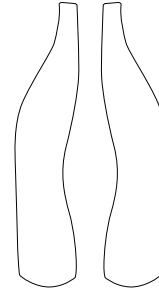

Top view of arms

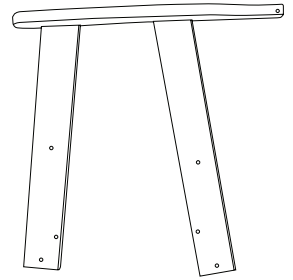

Side view of arms

**(D)** Rocker Bottoms - 2 pcs  
These are interchangeable

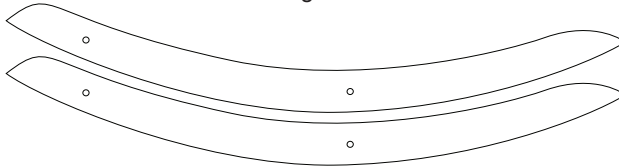

**(E)** Brace - 1 pc

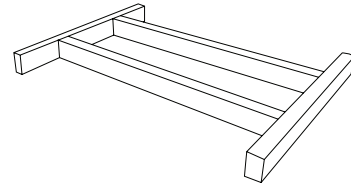

## Hardware - Shown at Actual Size

**(F)** 2.5" Bolts - 14 pcs



**(G)** Washers - 16 pcs



**(H)** Nut - 16 pcs



**(I)** 2.75" Bolts - 2 pcs



**Important:** When attaching the nuts, ALWAYS start with the metal part screwing onto the bolt/screw. Starting with the plastic part will not work and may cause the chair not to be properly assembled. See illustration to the right.



## Tools - Provided

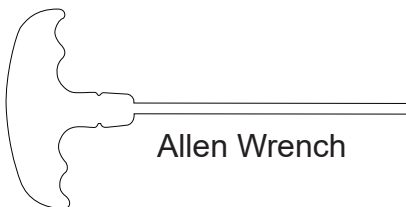

Allen Wrench

## Tools - Not Included

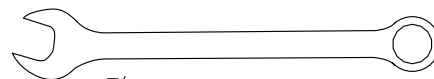

7/16 in. (11mm) open ended wrench

# Let's Get Started!

## Step 1 - Attach the Seat to the Arms

- Line up the top holes in the arms (C) to the holes on the side of the seat (B)
- Attach the arms (C) to the seat (B) using the hardware shown below

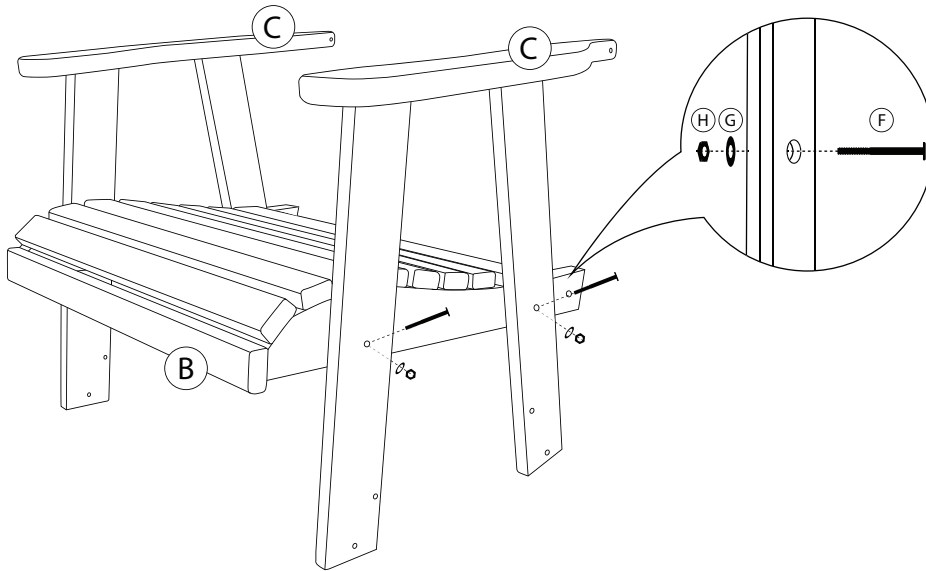

**Tip**

Lay the seat on its side when attaching the arms

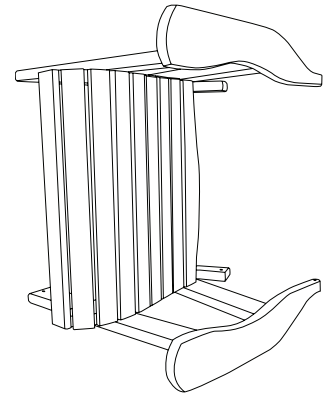

## Step 2 - Attach the Back to the Seat and Arms

- Lay the seat and arms front side down (see graphic below), and line up the holes in the bottom of the back (A) to the holes in the rear of the seat (B)
- The weight of the back will now cause the seat to rock forward slightly, where you can now attach the back to the arms using the 2 longer bolts.

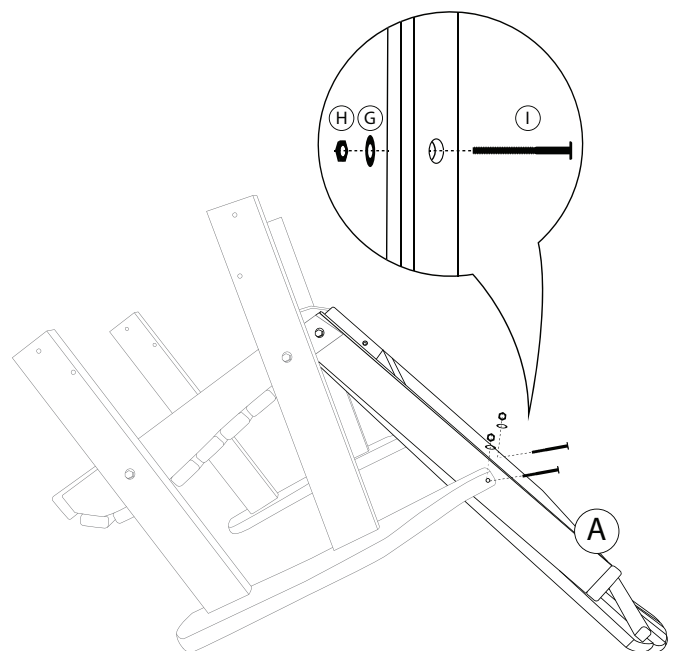
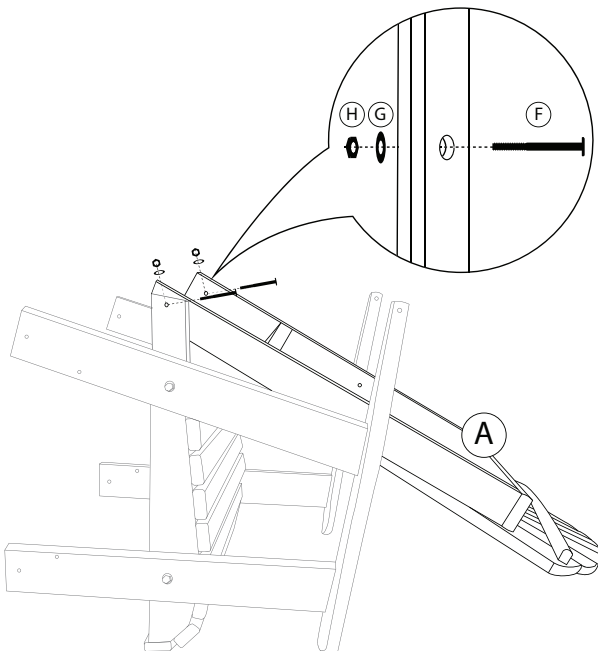

## Step 3 - Attach the Rocker Bottoms

---

- Position the rocker bottoms (D) to the outside of the arms (C). Make sure the short end of the rocker bottoms are facing front
- Attach the rocker bottoms using the hardware shown below

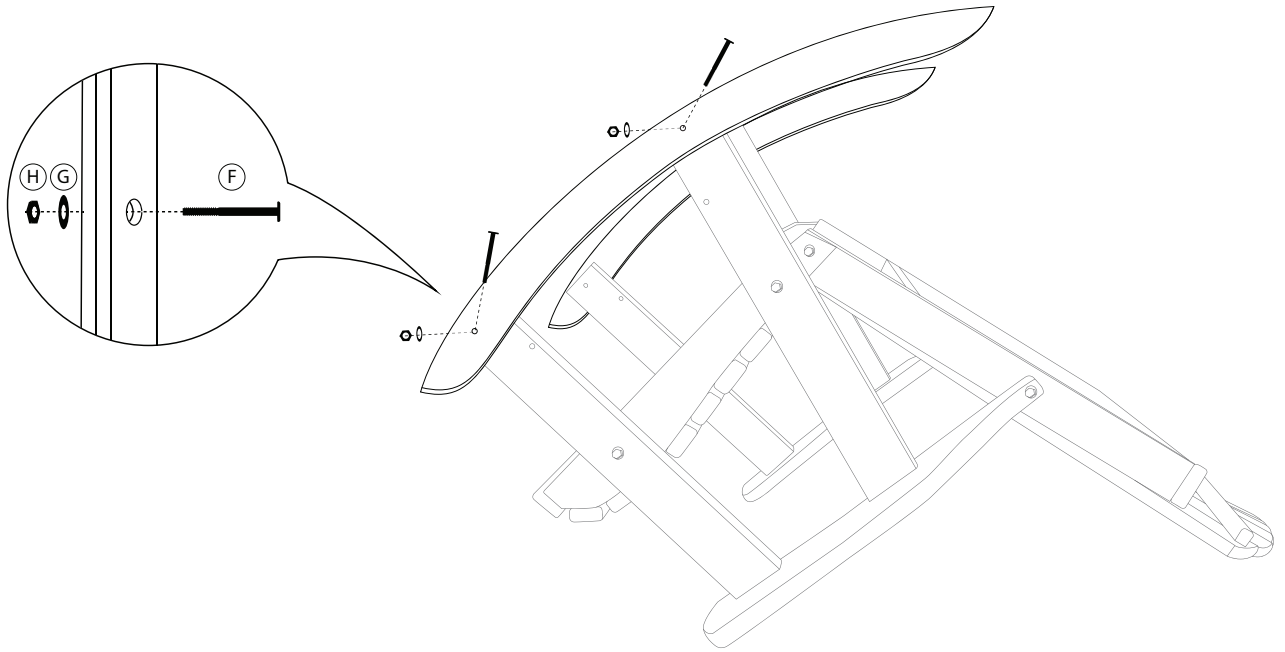

## Step 4 - Attach the Bottom Brace

---

- Place the brace (E) between the arms and attach it with the hardware shown below

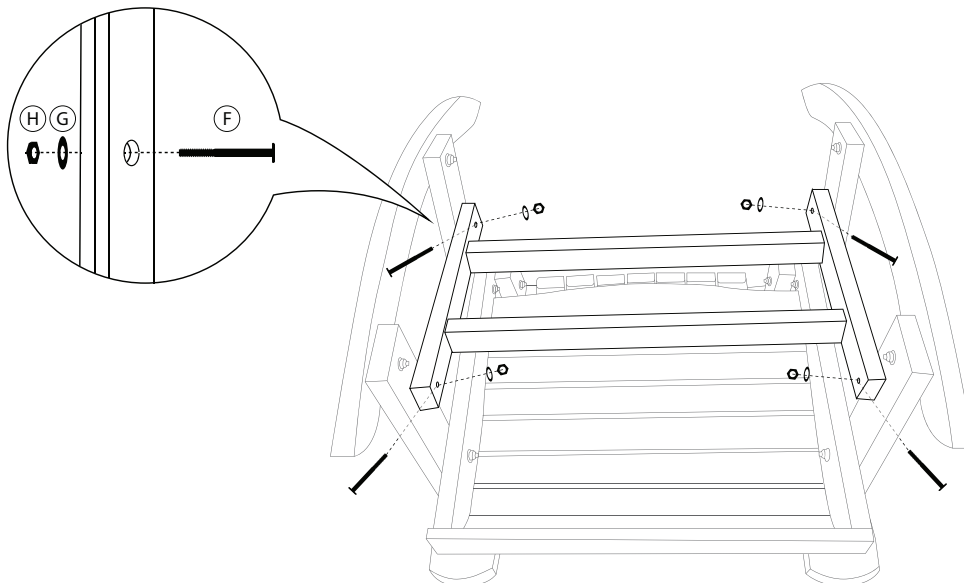

## Care

---

Poly lumber is easy to clean and maintain. Dust with a soft cloth or soft bristle brush, and tend to spills and stains with a mild soap and water. No waterproofing, no staining, and no painting is ever required! **IMPORTANT!** Periodically check to make sure that all screws are properly tightened.

That's all there is to it and now you have a comfortable rocker that we hope you will enjoy.  
Thank you for your business!